



Midway Village Museum
Rockford's
 HISTORY MUSEUM

Main Museum Exhibits

Inside the Museum Center, visitors explore Rockford's history through interactive exhibits in over 20,000 sq. feet of gallery space. Tours are available in Spanish; email educator@midwayvillage.com to arrange.

COMING SOON - You're in the Army Now: Camp Grant, Rockford's Legacy

Our capital campaign is underway to build a new permanent exhibit telling the story of Rockford's Camp Grant, where over 300,000 soldiers trained for World Wars I and II.

Many Faces, One Community

This exhibit features stories of Rockford's immigrants from 1834 to the present. Arrive through the train depot, stroll along 7th and South Main Streets, visit an immigrant home, and apply for a job at the Swedish furniture factory.

Queen City of the Prairies

Only 20 years after its founding, Rockford became an important regional center of government, industry and commerce. Learn more about life in 1840s Rockford.

The Girls of Summer

Meet the famous Rockford Peaches and learn about the storied ladies who played hardball in the 1940s-50s.

The Missing Link: Socks, Monkeys and Rockford's Industrial Past

View the Nelson knitting machines and learn about the red heel socks that earned Rockford the title of "Home of the Sock Monkey."

Flight Gallery

Learn about pioneering local aviators like Dr. Bessica Raiche, and see the restored 1920 SMI Stinson-Detroiter airplane named "Greater Rockford" that Col. Bert "Fish" Hassell flew in the failed first attempt at the Great Circle Route from Rockford to Stockholm.

Industrial Gallery

Rockford's industrial geniuses created innovative products that impacted the local and worldwide economy.

Old Doll's House Museum

Outside the Museum Center, the Old Doll's House Museum has 30 miniature homes representing different countries.

Woodward Millhouse

Tour an 1860s recreated mill with a functioning waterwheel located on Lake Severin. By appointment only.

Visit the Online Digital Collection

At midwayvillage.com you can browse over 5,000 digitized historical photographs documenting the history of the Rockford region.

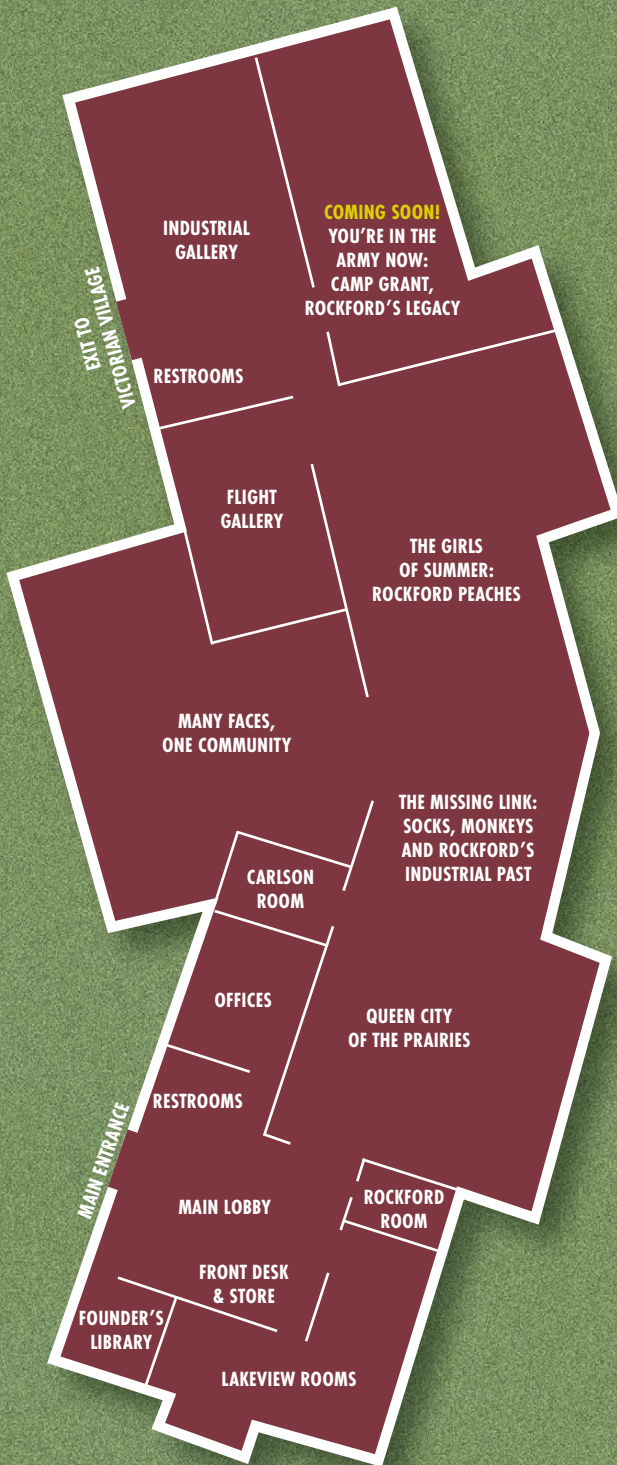

Maps of Museum Center and Victorian Village



Midway Village Museum
Rockford's
 HISTORY MUSEUM



ENTRANCE 3

P e r r y v i l l e

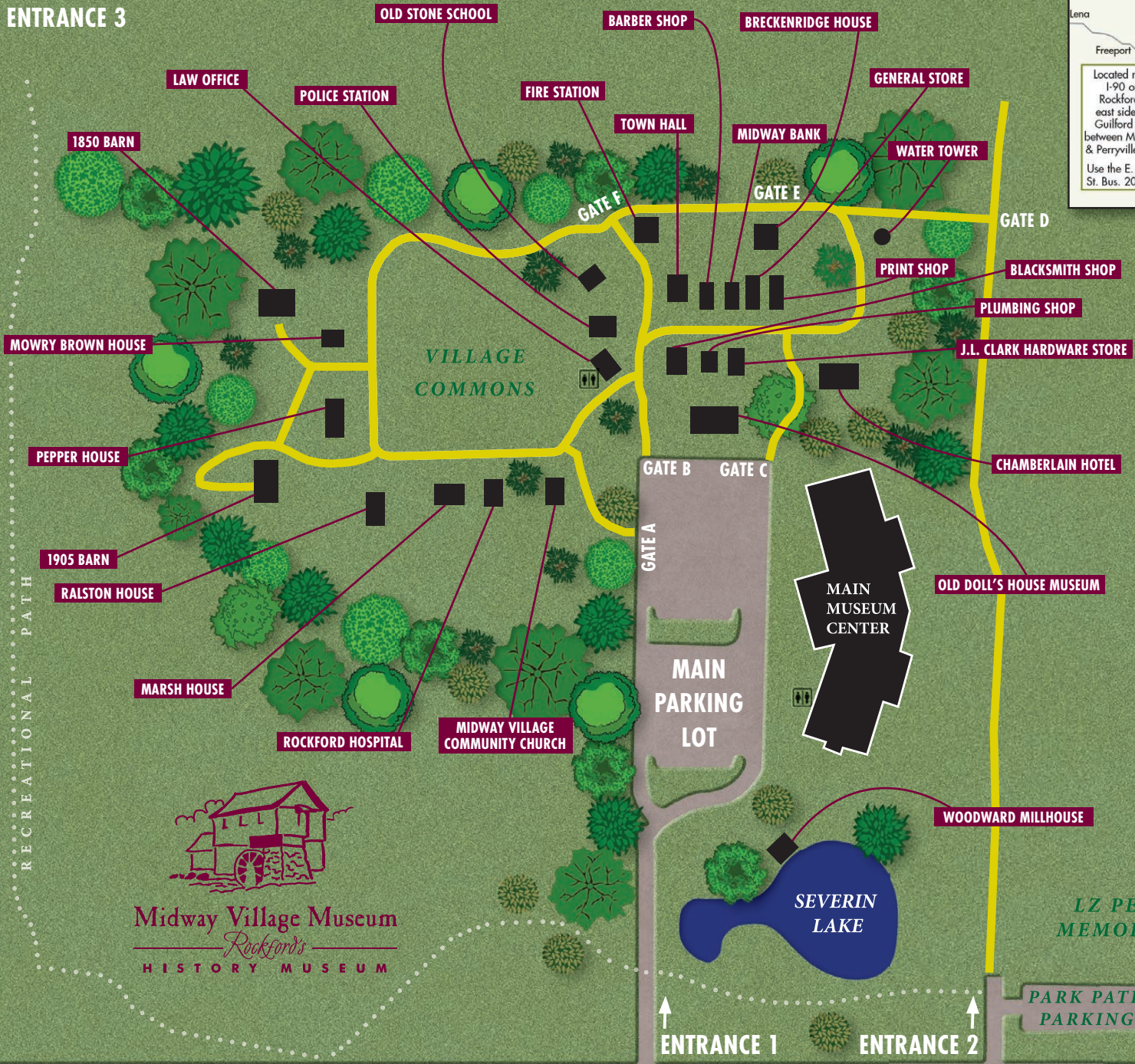

Visitors will learn about life between 1890-1910 by engaging with costumed History Interpreters in the Victorian Village. A variety of different people, technologies, lifestyles and cultures will be on display. Discover how life in the Rockford region has changed over the last 125+ years, and also how life has stayed the same. Living History Weekends will often feature a unique historical emphasis, with a focus on different technologies, activities and themes. Check midwayvillage.com for details before your visit!

LZ PEACE MEMORIAL



G u i l f o r d R d